



51 Waterloo Road, Ramsey IM8 1DZ £299,950

- Spacious Period Town House
- 4 Good Size Bedrooms
- 3 Reception Rooms
- Kitchen, Separate Utility Room, WC
- Newly Fitted Modern Bathroom
- Oil Fired Central Heating
- Upvc Double Glazed Windows
- Off Road Parking For 2 Vehicles, Lawned Garden

The Property

Spacious family home situated in the coastal town of Ramsey, close to all local amenities, bus route, shops, schools. The accommodation is over 3 floors with a lower level offering spacious Dining Room/Kitchen.

Outside at the rear you have an enclosed rear yard housing the Oil Boiler and across the service lane you have off road parking for 2 vehicles and a lawned garden.

Location

Travelling from Parliament Square turn immediately right and then first left onto Albert Street which then runs onto Waterloo Road, number 51 can be found situated on the right hand side clearly identified by our for sale sign.



BASEMENT
373 sq.ft. (34.7 sq.m.) approx.

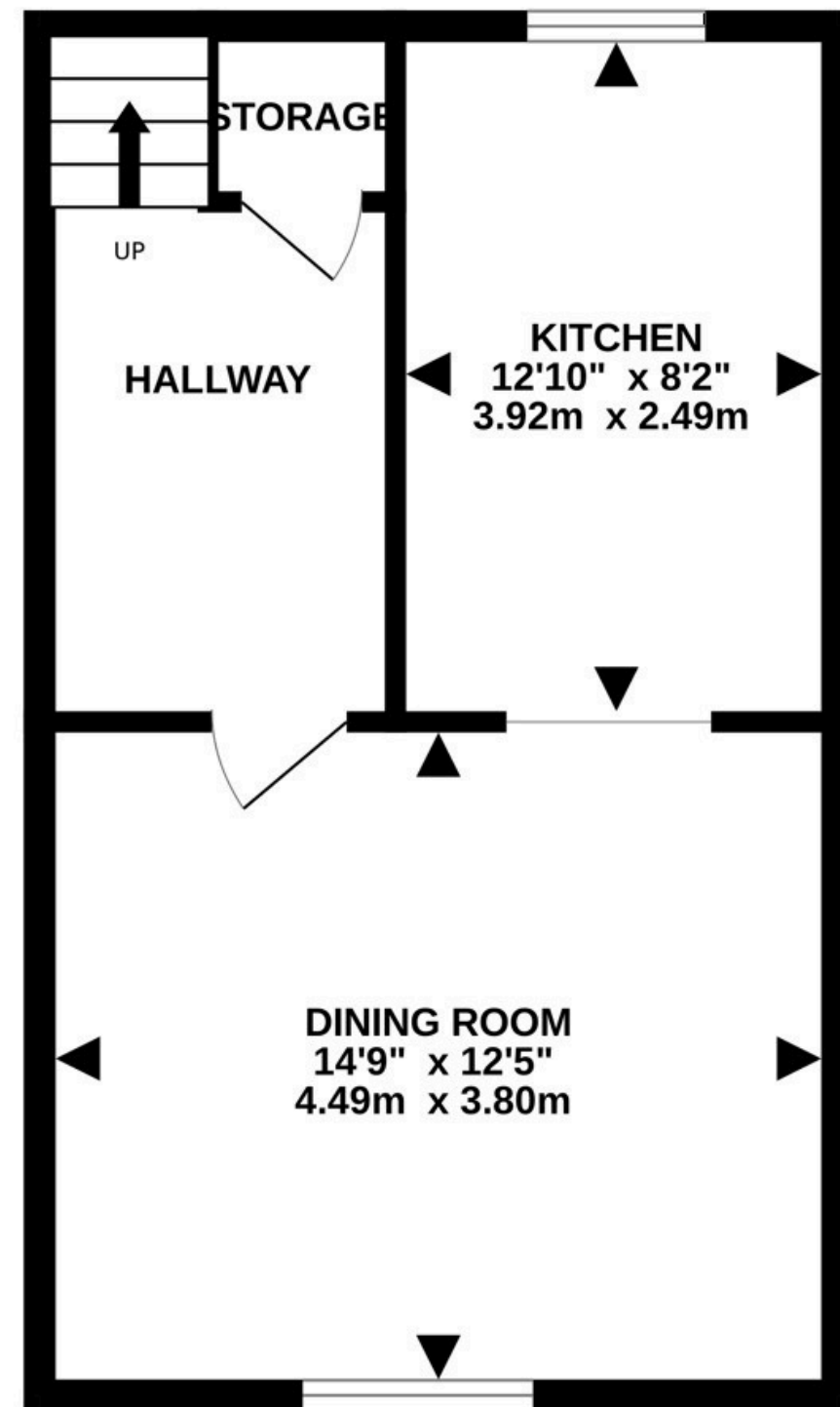

GROUND FLOOR
508 sq.ft. (47.2 sq.m.) approx.

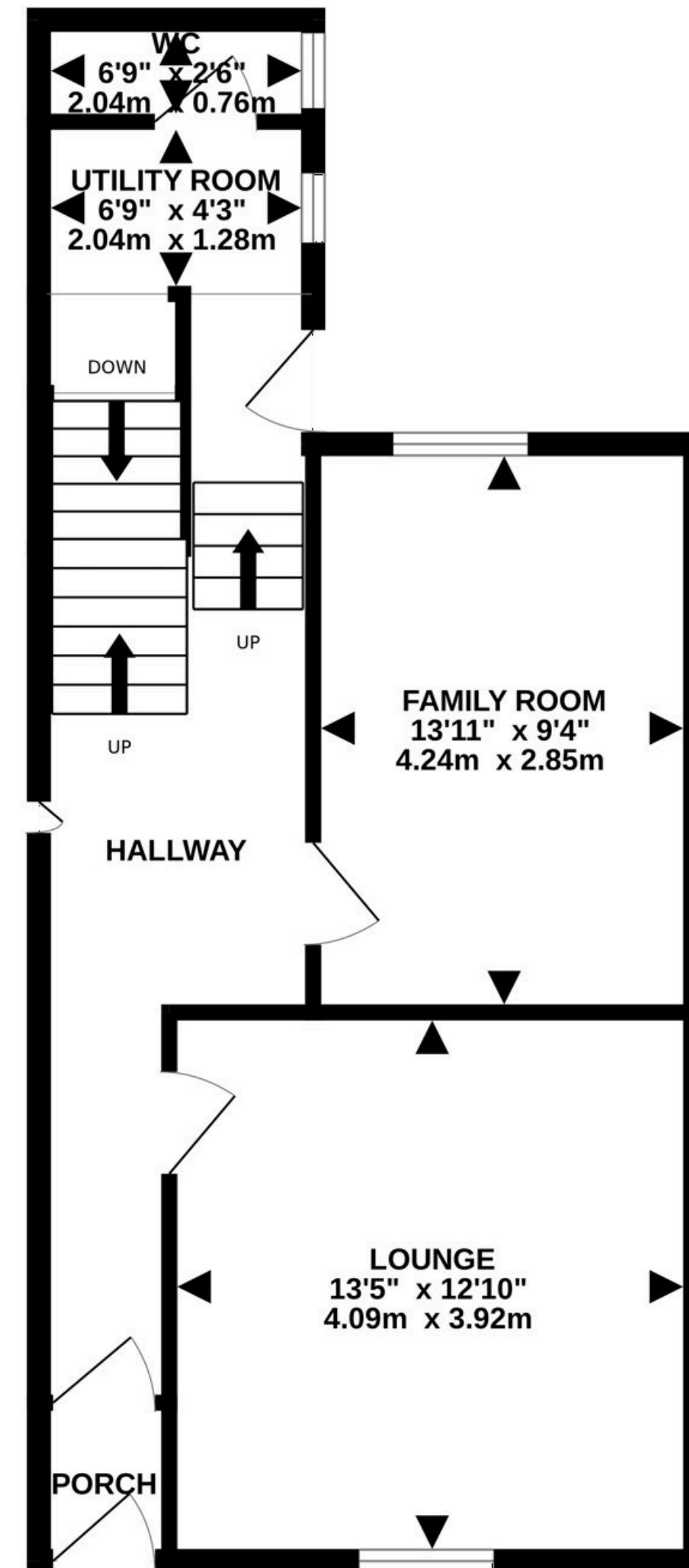

1ST FLOOR
459 sq.ft. (42.7 sq.m.) approx.

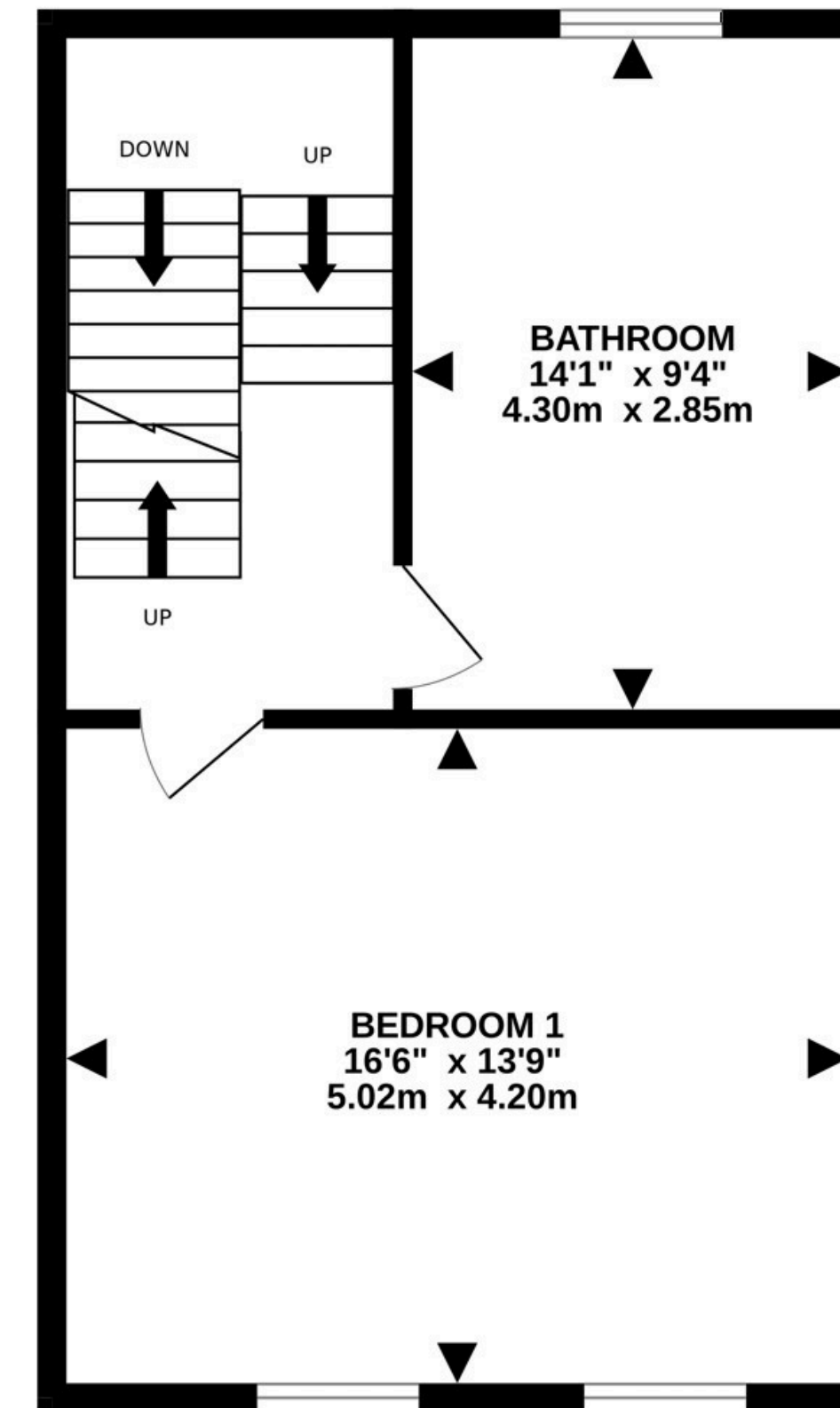

2ND FLOOR
421 sq.ft. (39.1 sq.m.) approx.

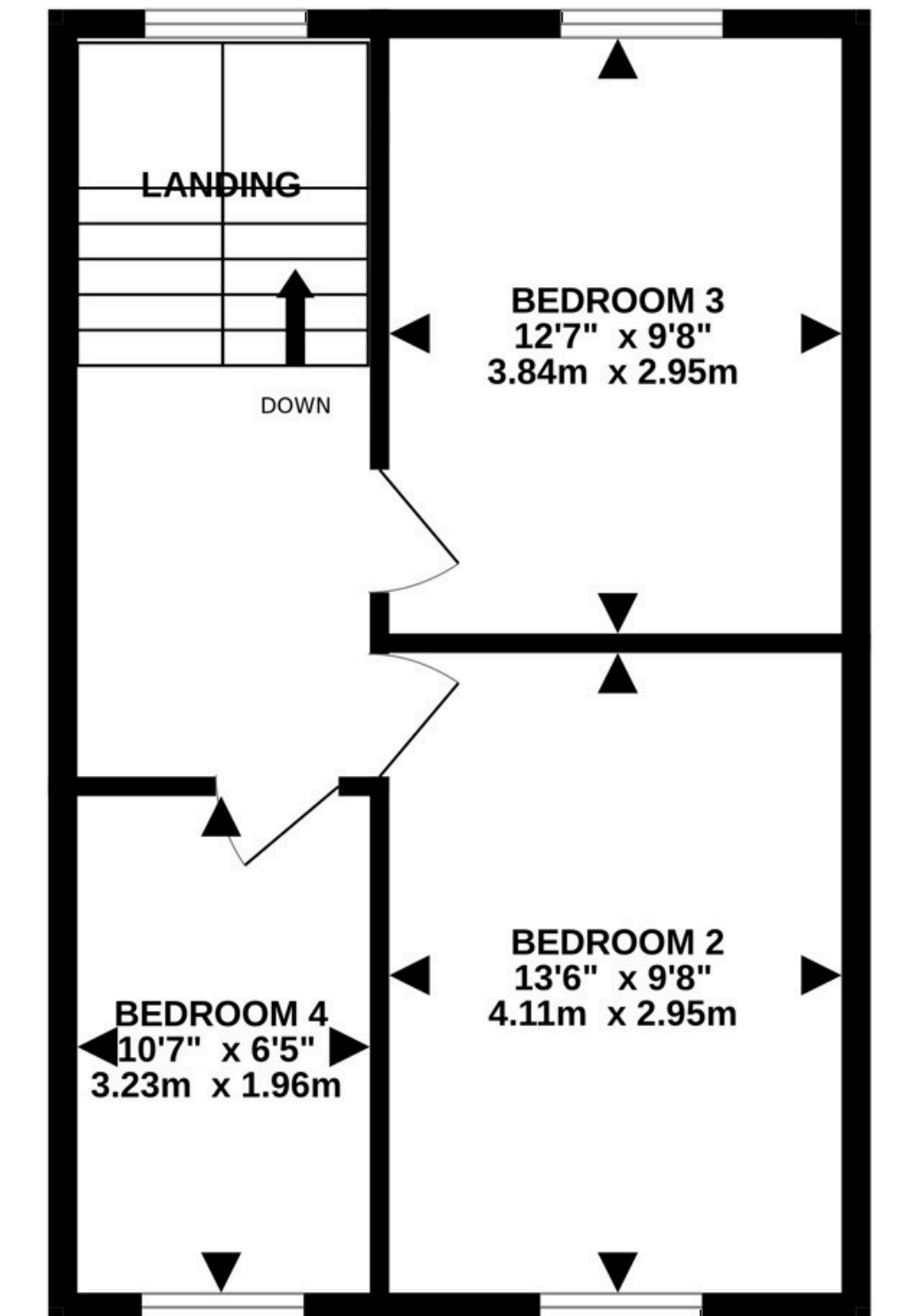

TOTAL FLOOR AREA : 1761 sq.ft. (163.6 sq.m.) approx.

Whilst every attempt has been made to ensure the accuracy of the floorplan contained here, measurements of doors, windows, rooms and any other items are approximate and no responsibility is taken for any error, omission or mis-statement. This plan is for illustrative purposes only and should be used as such by any prospective purchaser. The services, systems and appliances shown have not been tested and no guarantee as to their operability or efficiency can be given.

Made with Metropix ©2025

Disclaimer: Whilst all particulars are believed to be correct, neither Property Wise Limited, or their clients guarantee their accuracy nor are they intended to form part of any contract. Floorplans are only for illustrative purposes only, decorative finishes, fixtures, fittings and furnishings do not represent the current state of the property. Measurements are approximate and not to scale.

