



FOR SALE
propertywise.co.uk
THE WISE MOVE
662820
Branches island wide

- Well Presented 5 Bedroom Town House
- 2 Large Living/Family Rooms
- Good Sized Modern Kitchen
- Master Double Bedroom With Ensuite
- Further 4 Double Bedrooms
- Family Bathroom and A Further Shower Room
- Finished To A Lovely Standard
- Parking To The Rear of The Property

The Property and Location

This Well Presented 5 Bedroom Town House Sits In The Heart of Ramsey conveniently positioned within walking distance to all of Ramsey Towns Shops, Mooragh Park, and all of the towns Amenities and Schools. This property has been well maintained and decorated and has lovely wooden flooring throughout the very spacious ground floor living areas. This is an ideal property for a family.

Ground Floor

The Front Porch opens up into a lovely entrance hall. At the end of the hallway sits a very useful ground floor shower room and WC. A spacious light and sunny lounge sits to the front of the property that leads through to a beautiful generous sized dining area which currently hosts a working solid fuel aga. To the rear of this room you can walk into the galley style modern kitchen that sits at the back of the house that has plenty of cupboard space.

1st and 2nd Floor

The first floor offers the Master Bedroom with Ensuite shower room, a double bedroom, good sized Modern Bathroom and a large laundry/storage cupboard.

On the second floor there is a further spacious double bedroom, attic double bedroom with a dressing area and a further double bedroom.

General

Gas Central Heating, A small tidy garden to the front that is gated.

A rareity for a Town House is that although it doesnt have a rear garden it does have its own 2 Parking spaces to the rear of the property.





GROUND FLOOR
501 sq.ft. (46.6 sq.m.) approx.

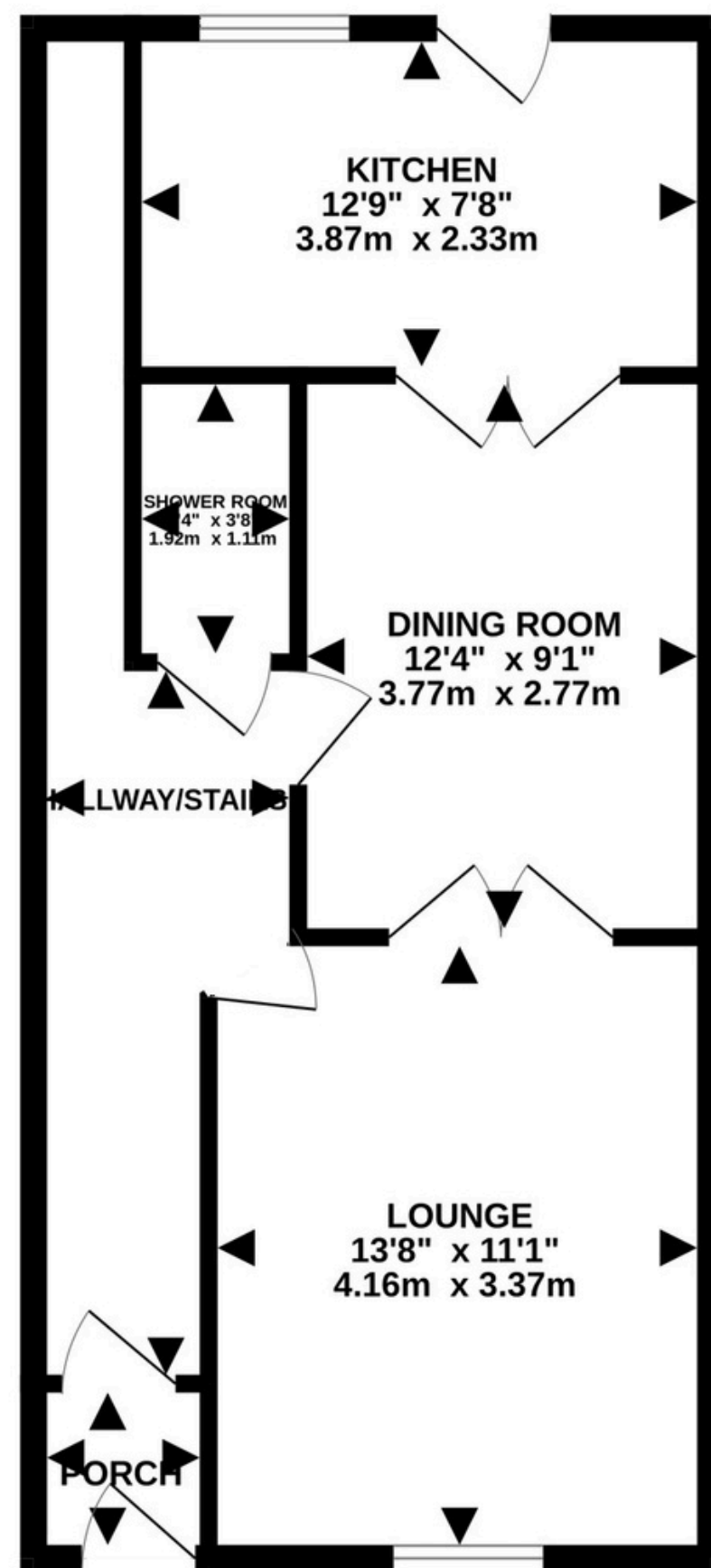

1ST FLOOR
102 sq.ft. (9.5 sq.m.) approx.

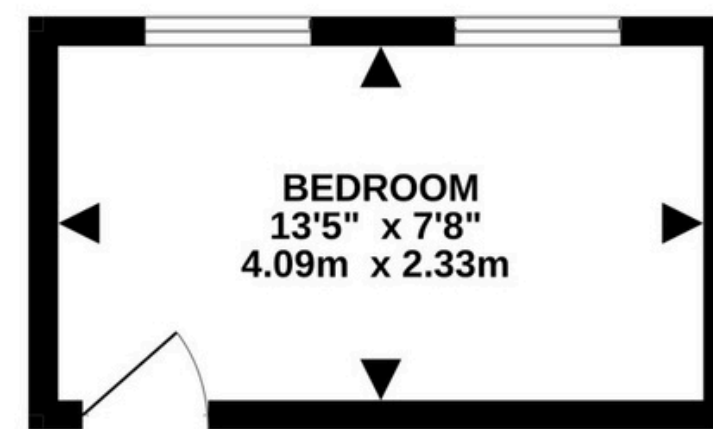

2ND FLOOR
301 sq.ft. (27.9 sq.m.) approx.

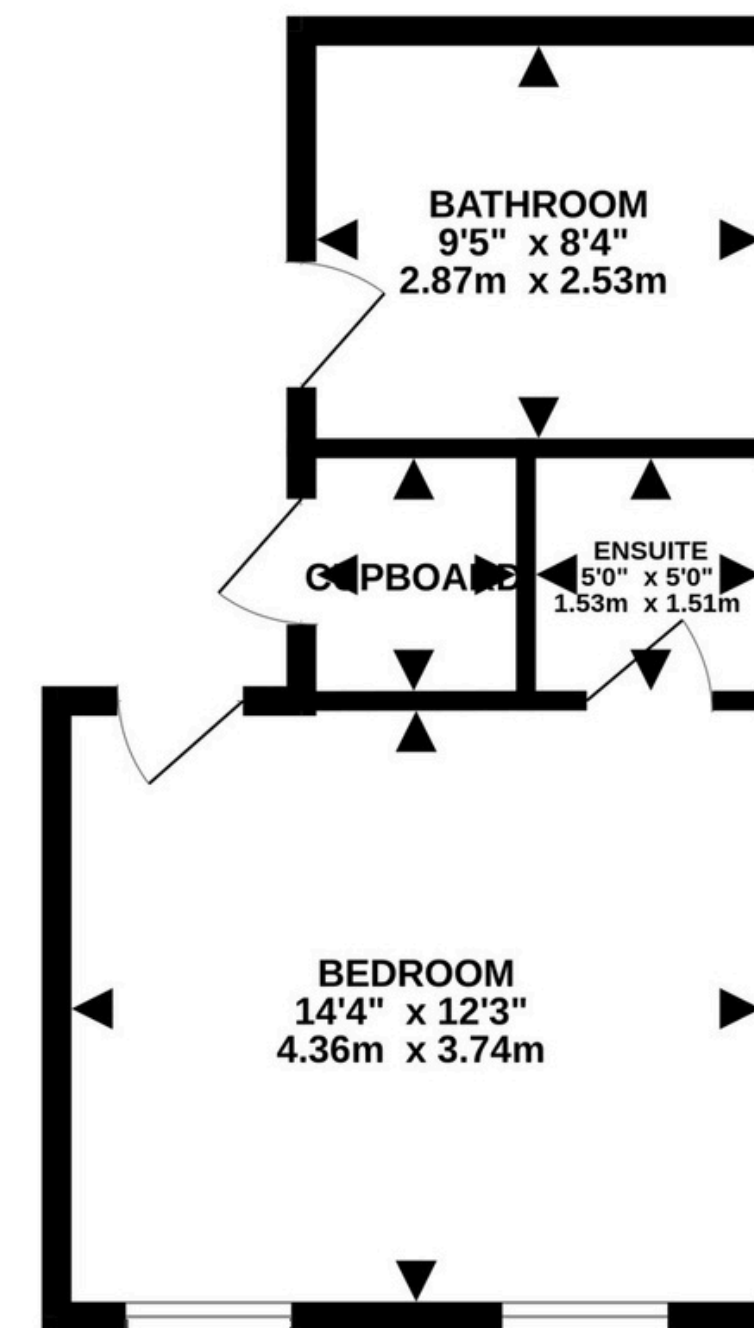

3RD FLOOR
447 sq.ft. (41.5 sq.m.) approx.

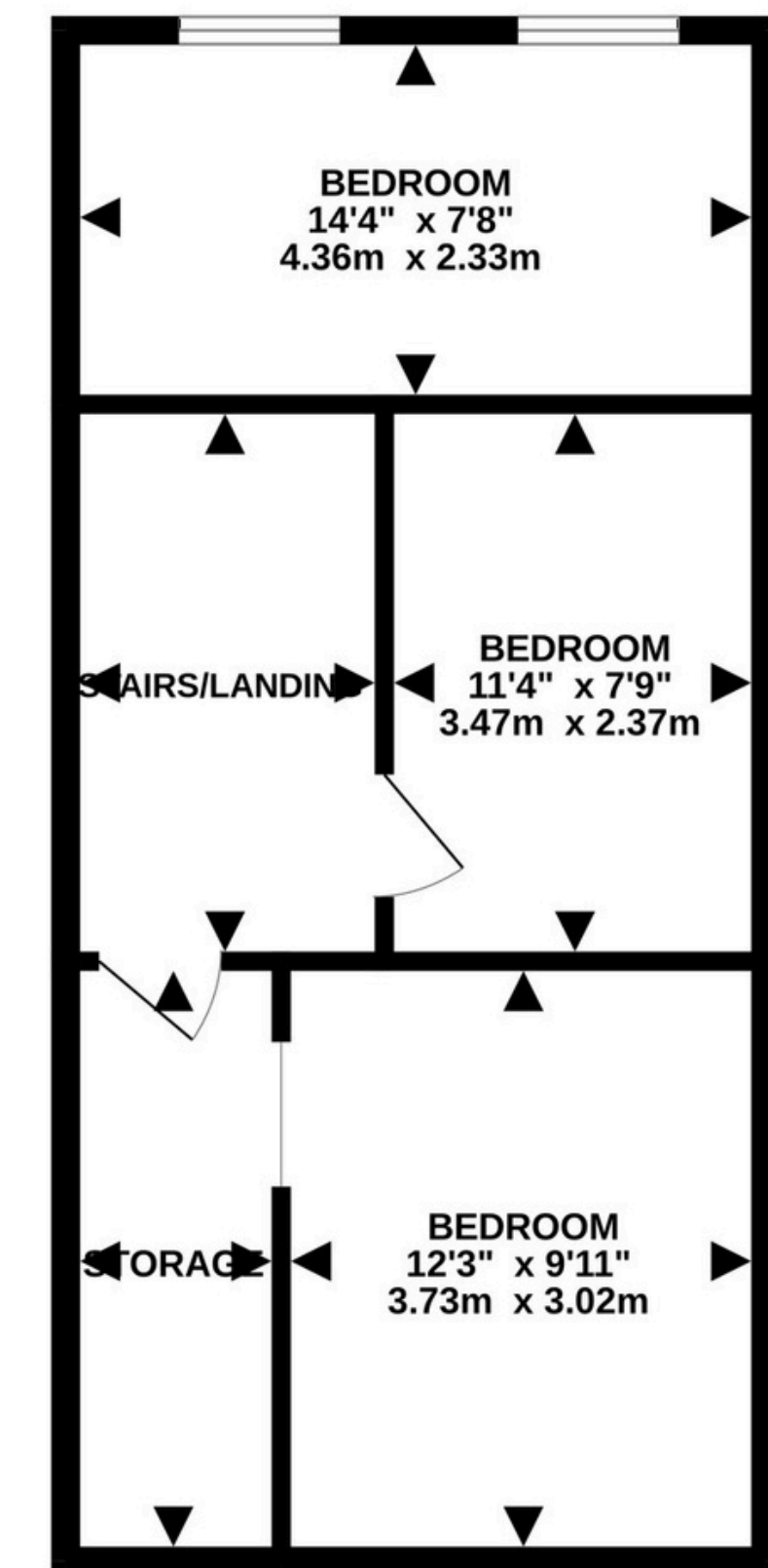

TOTAL FLOOR AREA : 1351 sq.ft. (125.5 sq.m.) approx.

Whilst every attempt has been made to ensure the accuracy of the floorplan contained here, measurements of doors, windows, rooms and any other items are approximate and no responsibility is taken for any error, omission or mis-statement. This plan is for illustrative purposes only and should be used as such by any prospective purchaser. The services, systems and appliances shown have not been tested and no guarantee as to their operability or efficiency can be given.
Made with Metropix ©2025