

25 Christian Road, Douglas

Asking Price £369,950



Extremely Well Presented Mid Terraced House

Situated in a Central Convenient Location Within a Stones Throw from City Centre and Amenities

The Property Comprises:

Large Lounge (With Multi Fuel Burner)

Dining Room

Modern Dining Kitchen

5 Good Sized Bedrooms (1 with Ensuite and 1 with Large Dressing Room)

Spacious Attic Room

Downstairs and Upstairs WC's

Oil Fired Central Heating and uPVC Double Glazed Throughout (New Composite Front Door)

Yard at Rear Providing Off Road Parking for 1 Car Accessed Via Roller Door (Plus Newly Paved Front)

Viewing Highly Recommended on this Super Value for Money Family Home

**Directions:** Travelling out of Douglas up Prospect Hill Through the Circular Road Junction on to Bucks Road, Take the 3rd Right (at Islander Chippy) on to Christian Road Where no 25 can be easily Located on the Right Hand Side.



GROUND FLOOR  
1138 sq.ft. (105.7 sq.m.) approx.

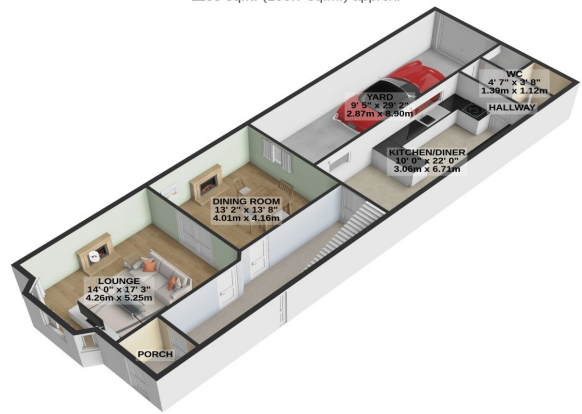

1ST FLOOR  
898 sq.ft. (83.4 sq.m.) approx.

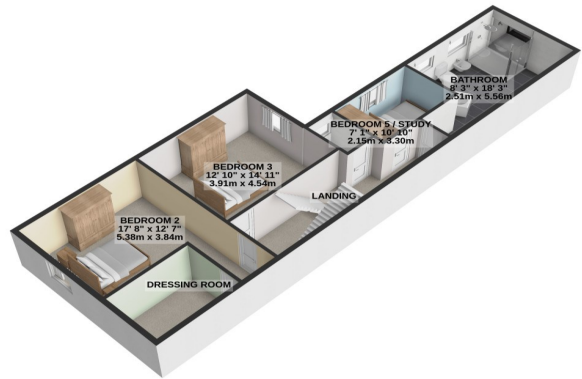

2ND FLOOR  
564 sq.ft. (52.4 sq.m.) approx.

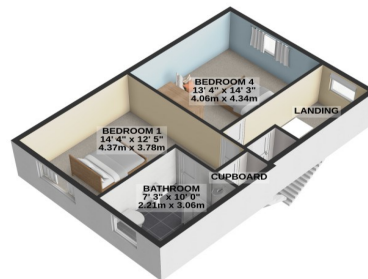

3RD FLOOR  
286 sq.ft. (26.5 sq.m.) approx.

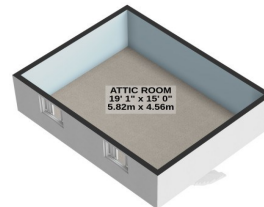

TOTAL FLOOR AREA : 2886 sq.ft. (268.1 sq.m.) approx.

For illustrative purposes only. Decorative finishes, fixtures, fittings and furnishings do not represent the current state of the property. Measurements are approximate. Not to scale. Made with Metropix © 2024

Property Wise Limited, First Floor, St. Georges Chambers,  
1 Athol Street, Douglas, Isle of Man, IM1 1LD

Email: Info@propertywise.co.im

