

**17 Heather Lane, Abbeyfields, Douglas**

**Asking Price £299,950**



**Attention Investors and First Time Buyers**  
**Well Positioned Semi Detached House**  
**Situated in a Quiet Cul de Sac Residential Location**  
**Close to Local Schools Shops and Amenities**  
**Large Lounge**  
**Dining Kitchen**  
**3 Bedrooms**  
**Family Bathroom**  
**Gas Fired Central Heating**  
**uPVC Double Glazing**  
**Good Sized Sunny Rear Garden**  
**Parking for 2 Cars**  
**Viewings Highly Recommended**

**Directions:** Travelling North up Johnny Wattersons Lane, Take the Last Turning on the Right in to  
Campion Way then Third Left in to Heather Lane Where the Property Can be Located at the Top on  
the Right Hand Side

GROUND FLOOR  
381 sq.ft. (35.4 sq.m.) approx.

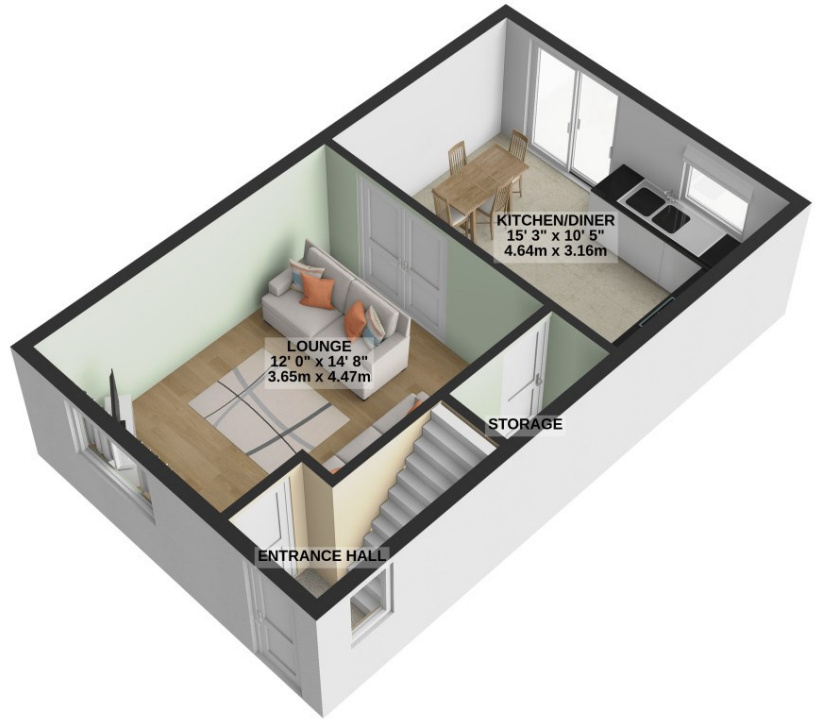

1ST FLOOR  
381 sq.ft. (35.4 sq.m.) approx.

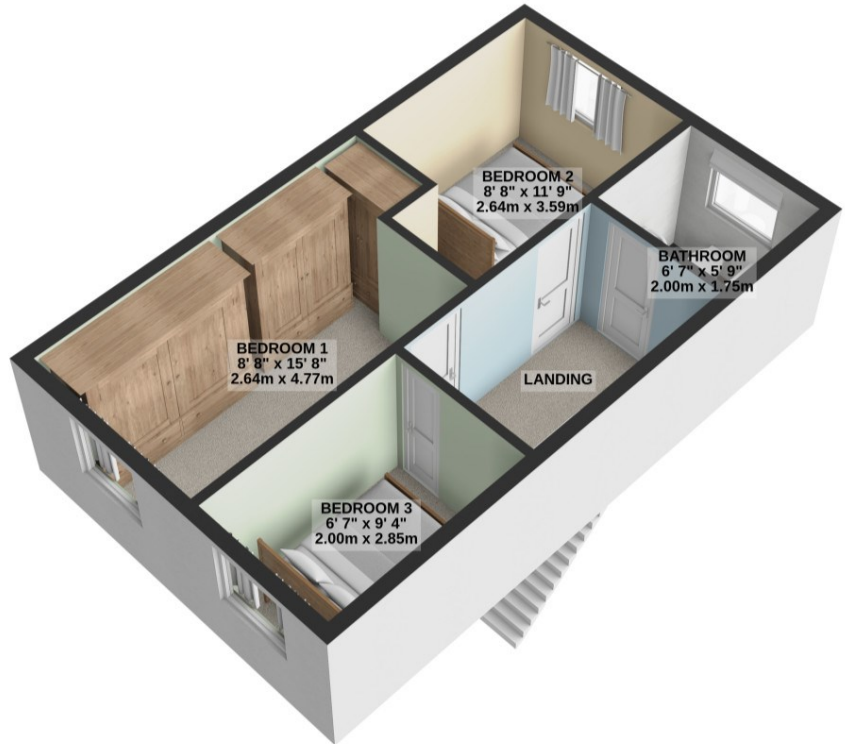

TOTAL FLOOR AREA : 763 sq.ft. (70.9 sq.m.) approx.

For illustrative purposes only. Decorative finishes, fixtures, fittings and furnishings do not represent the current state of the property. Measurements are approximate. Not to scale.  
Made with Metropix © 2024