

2 Coronation Court

Ramsey

£415,000



**Delightful Extended 3 Bedroom Bungalow, Immaculately Presented Throughout
and Situated in the Heart of Ramsey
Walking Distance to Ramsey Town Centre, Beach, Mooragh Park, Schools,
Hospital and Doctors Surgery**

Accommodation Comprises:-

Entrance Hall With Stairs To First Floor

**Good Sized Lounge that Leads Into The Sun Room / Dining Room
with Double Doors onto the Decking**

**Good Sized Modern Fitted Kitchen With Electric Rangemaster and Induction Hob,
Centre Island and Separate Utility Area**

2 Double Bedrooms Downstairs (One Currently Used As a Dining Room)

Family Shower Room and Cloaks Cupboard

**Upstairs Boasts A Further Double Bedroom and Large Contemporary Bathroom With Jacuzzi
Bath and Separate Walk In Wet Room Area**

Oil Fired Central Heating, uPVC Double Glazed Throughout

**South Facing Rear Garden and Separate Large Patio Area Which Is Ideal for Entertaining
Garage and Parking for Several Vehicles to Front and Side**

Directions: Travelling north along Douglas Promenade turn left up Summerhill and Holly Cottage can be seen in front of you at the roundabout at the top just before Corkill's Garage.

Rates payable: TBA

Inclusions: to be confirmed

Services: All Major Services

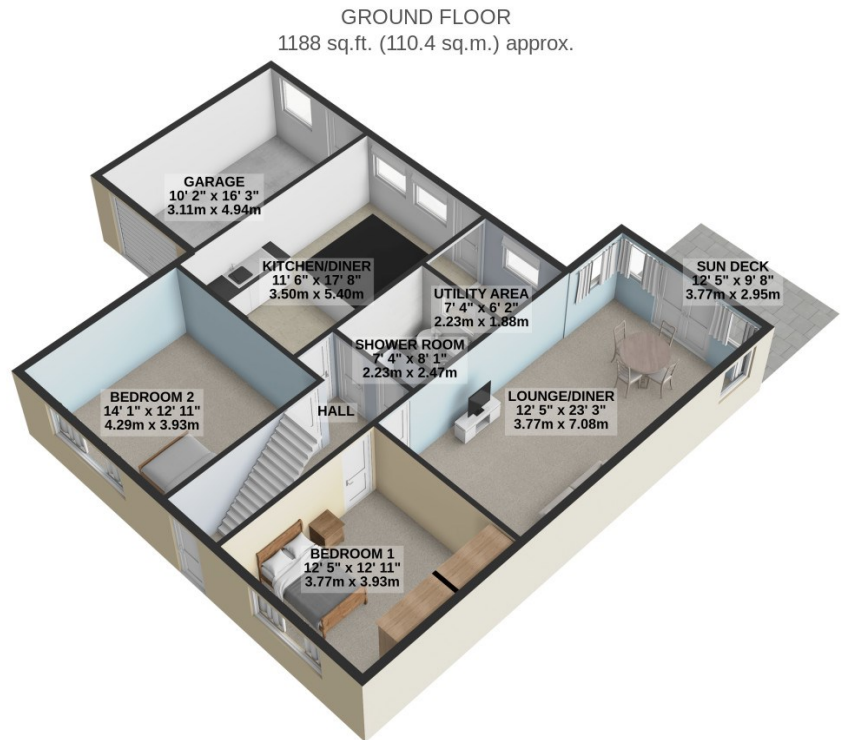

1ST FLOOR
313 sq.ft. (29.1 sq.m.) approx.

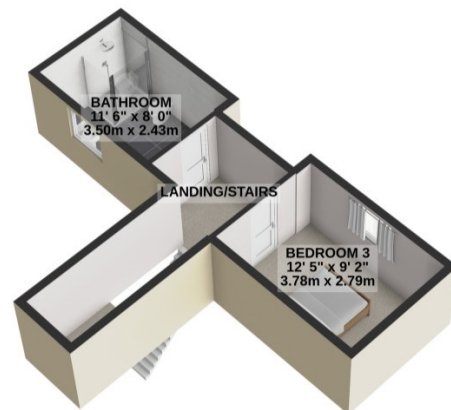

TOTAL FLOOR AREA: 1501 sq.ft. (139.5 sq.m.) approx.

For illustrative purposes only. Decorative finishes, fixtures, fittings and furnishings do not represent the current state of the property. Measurements are approximate. Not to scale. Made with Metropix © 2024