

**At Last  
The Level, Colby  
£344,000**



**Beautifully Located, Spacious Semi Detached Family Home, Close To Local Shops, Schools & Amenities, With Panoramic Views.**

Entrance Hall Lounge With Open Fireplace  
Modern Kitchen With Utility Area & Downstairs WC  
Separate Dining Room  
Conservatory With Patio Doors Leading To Sunny Rear Garden  
3 Bedrooms & Large 4th Attic Bedroom With Eaves Storage  
Modern 4 Piece Family Bathroom  
Oil Central Heating, UPVC Double Glazing  
Separate Garage/Off Road Parking For 3 Vehicles  
\*\*\*\*\*Viewing's Highly Recommended\*\*\*\*\*

Directions : Travelling Through Port Erin, Heading Up The Promenade Towards The Golf Course, Take The First Right Hand Turn After Bay View Road Onto Maine Road. The Property Will Be Found A Short Distance Along On The Right Hand Side.

Rates : Please contact the Isle of Man Rates Office on 685661 for Current Rates

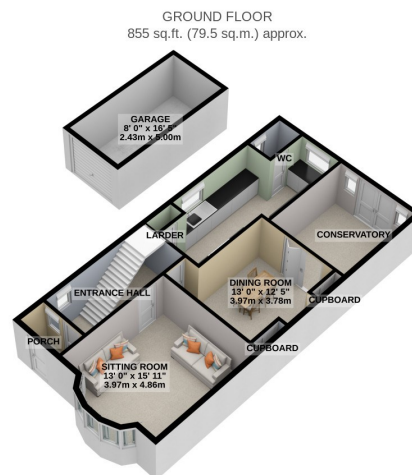

1ST FLOOR  
574 sq.ft. (53.4 sq.m.) approx.

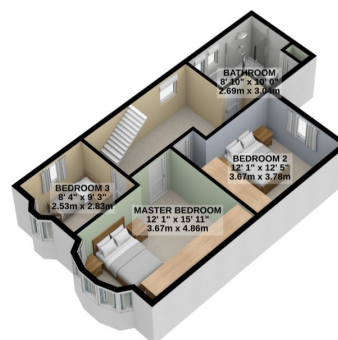

2ND FLOOR  
435 sq.ft. (40.4 sq.m.) approx.

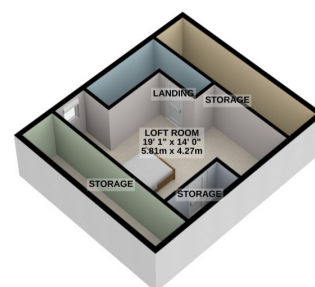

SEMI DETACHED  
TOTAL FLOOR AREA : 1865 sq.ft. (173.2 sq.m.) approx.

For illustrative purposes only. Decorative finishes, fixtures, fittings and furnishings do not represent the current state of the property. Measurements are approximate. Not to scale.  
Made with Metropix © 2020