

53 Hillberry Heights, Governors Hill Douglas

Asking Price £325,000



Deceptively Spacious Modern Semi Detached House

Situated in a Much Sought Residential Location, Close to Local Schools, Shops and Amenities

Accommodation Comprises:

Lounge

Dining Kitchen

Sun Room Extension

3 Bedrooms

Family Bathroom

Gas Fired Central Heating

uPVC Double Glazed Throughout

Enclosed Low Maintenance Rear Garden

Driveway Providing Parking for 2 - 3 Cars

Directions: Travelling Out of Douglas up Victoria Road turning Right at the Top on to Governors Road, then Left at the 2nd Roundabout, Proceed up the Hill Turning Left at the Pillars in to Hailwood Avenue, Take Next Left on to Lakeside Road Then 2nd Right on to Hillberry Heights Where the Property can be Easily Located on the Left Hand Side



GROUND FLOOR
692 sq.ft. (64.3 sq.m.) approx.

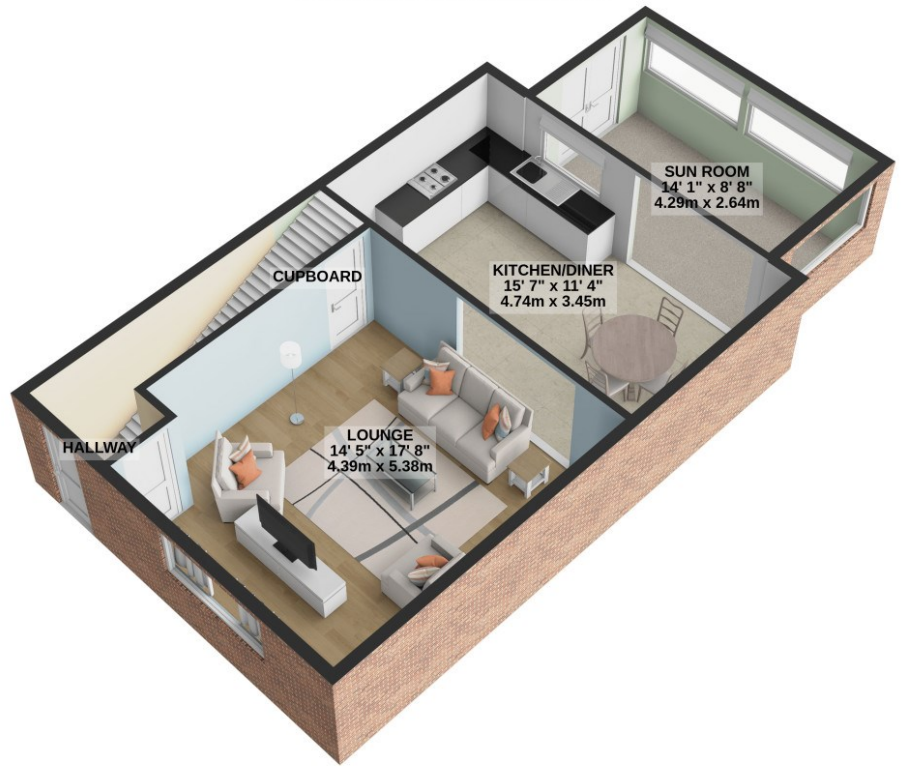

1ST FLOOR
568 sq.ft. (52.7 sq.m.) approx.

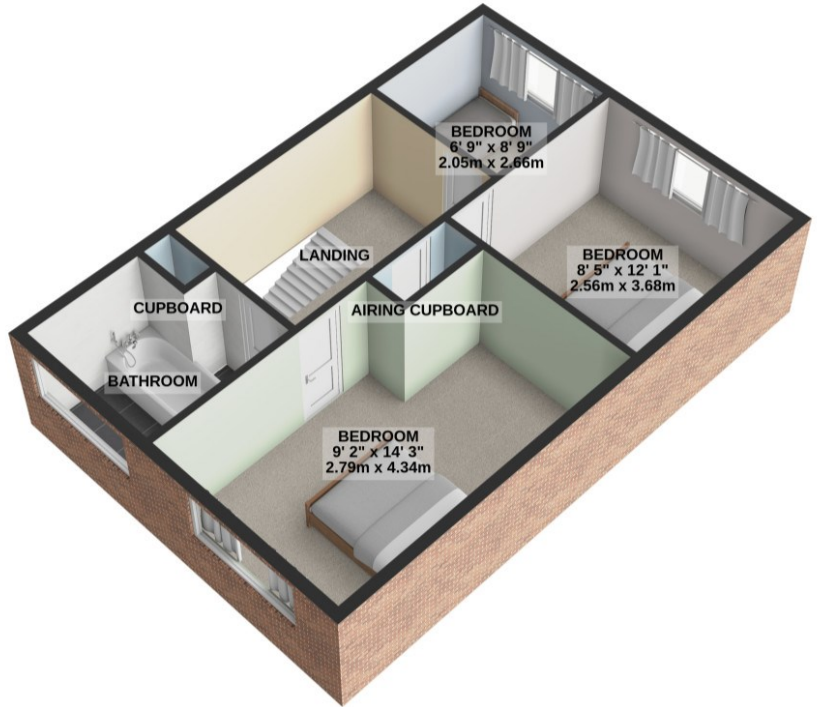

TOTAL FLOOR AREA : 1260 sq.ft. (117.0 sq.m.) approx.

For illustrative purposes only. Decorative finishes, fixtures, fittings and furnishings do not represent the current state of the property. Measurements are approximate. Not to scale.
Made with Metropix © 2024

Property Wise Limited, First Floor, St. Georges Chambers,
1 Athol Street, Douglas, Isle of Man, IM1 1LD

Email: Info@propertywise.co.im