

**“Thie Sonney”  
May Hill, Ramsey  
£285,000**



**Delightful Detached Bungalow Situated in a Sought After Area, Walking Distance to Ramsey Town Centre and all Amenities.**

**Accommodation Comprises:-**

**Entrance Hall, Lounge, Fitted Kitchen,  
Two Double Bedrooms (both with fitted wardrobes), Family Bathroom,  
Single Garage and Parking (possible to extend parking, subject to  
relevant planning permissions)**

**Generous Enclosed Rear Garden with Lawn, Mature Hedging and Fruit  
Trees.**

**Oil Fired Central Heating, Double Glazed.**

**“Ideal Starter Home or Investment Property”**

**Directions:** Travelling From Parliament Square Up May Hill towards the Mountain Road just before the turning onto Lheaney Road, the property can be found on the left hand side easily identified by our 'for sale' board.

**Rates payable:** contact the rates office on 685681

**Inclusions:** to be confirmed



GROUND FLOOR  
663 sq.ft. (61.6 sq.m.) approx.

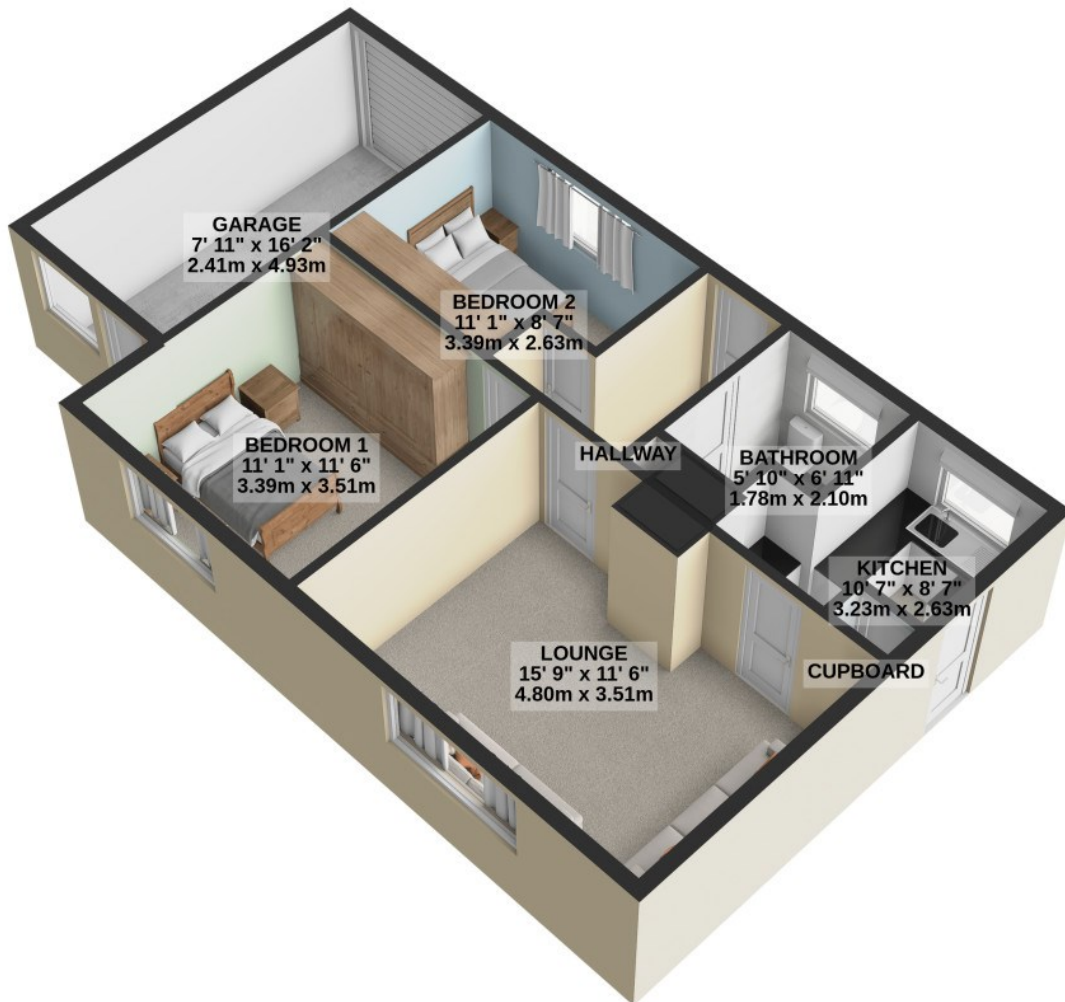

TOTAL FLOOR AREA : 663 sq.ft. (61.6 sq.m.) approx.

For illustrative purposes only. Decorative finishes, fixtures, fittings and furnishings do not represent the current state of the property. Measurements are approximate. Not to scale.

Made with Metropix © 2024