

Apt 3 Athol Buildings

Peel

£134,950



**A Delightful One Bedroom Purpose Built Modern Apartment Sat In The Heart of Peel
Within Walking Distance To All Shops, The Sea Front And All Amenities**

Located on The 1st Floor The Accommodation Comprises:-

Lovely Dual Aspect Sunny Lounge with Views Overlooking The Harbour Wall and Sea

Good Sized Kitchen With Electric Oven

Spacious Double Bedroom

Family Bathroom

Gas Central Heating

Ideal First Time Mortgage or Investment Property

Double Glazing Throughout

Directions: Travelling Into Peel From Douglas Turn Left at The Crossroads Along Albany Road. Turn Left Down the One Way At The Police Station , Past The Cathedral and Athol Buildings is on your right at the Road Junction of Athol Place.

Rates payable: TBA Management Fee—Approx £120.00 Per Month

Inclusions: to be confirmed

Services: All Major Services



GROUND FLOOR
563 sq.ft. (52.3 sq.m.) approx.

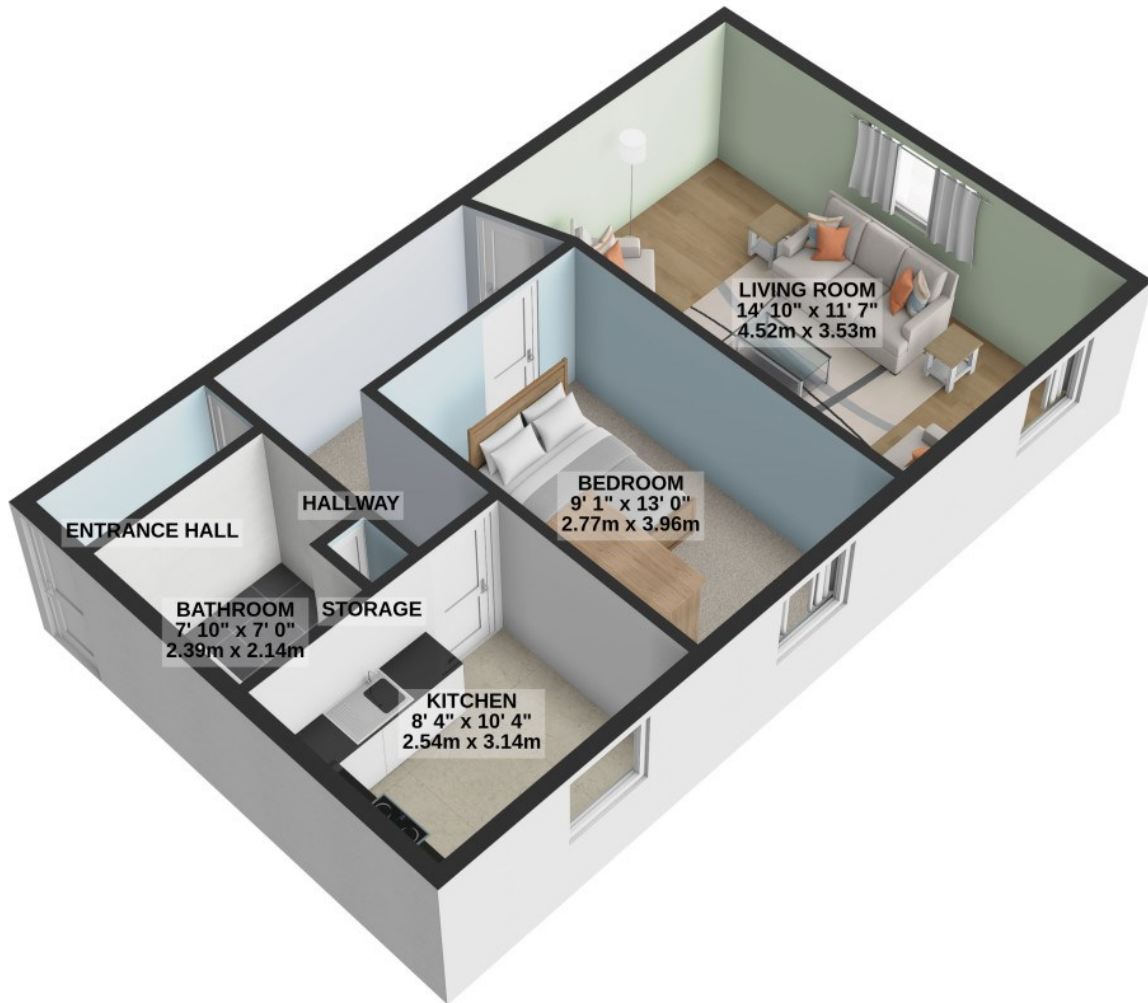

TOTAL FLOOR AREA : 563 sq.ft. (52.3 sq.m.) approx.

For illustrative purposes only. Decorative finishes, fixtures, fittings and furnishings do not represent the current state of the property. Measurements are approximate. Not to scale.

Made with Metropix © 2024