

66 Summerhill Road, Onchan

Asking Price 395,000



Beautiful Deceptively Spacious Semi Detached House

Fully Renovated and Refurbished Throughout

Situated on a Large Plot Close to Shops, Schools & Local Amenities

Accommodation Comprises:

Very Spacious Light and Airy Lounge

New Fully Fitted Kitchen Diner

Utility Room / Downstairs WC

3 Bedrooms

Beautiful Newly Fitted Modern 3 Piece Family Bathroom

Large Private Rear Garden with Fully Blossomed Apple Tree

Single Garage with Newly Fitted Electric Roller Door and Off Road Driveway Parking

Gas Fired Central and Heating uPVC double glazing

Viewings Highly Recommended

Directions: Travelling North Along Douglas Promenade, Turn Left (Before the Tram Terminus and Terminus Pub) Up Summerhill Road Where Number 66 Can Be Found on the Right hand side clearly identified by our For Sale Board.

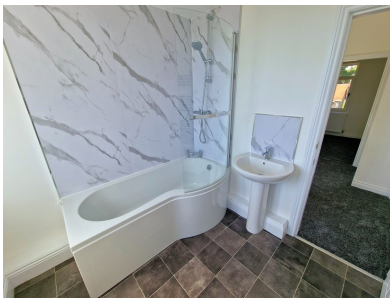

GROUND FLOOR
655 sq.ft. (60.9 sq.m.) approx.

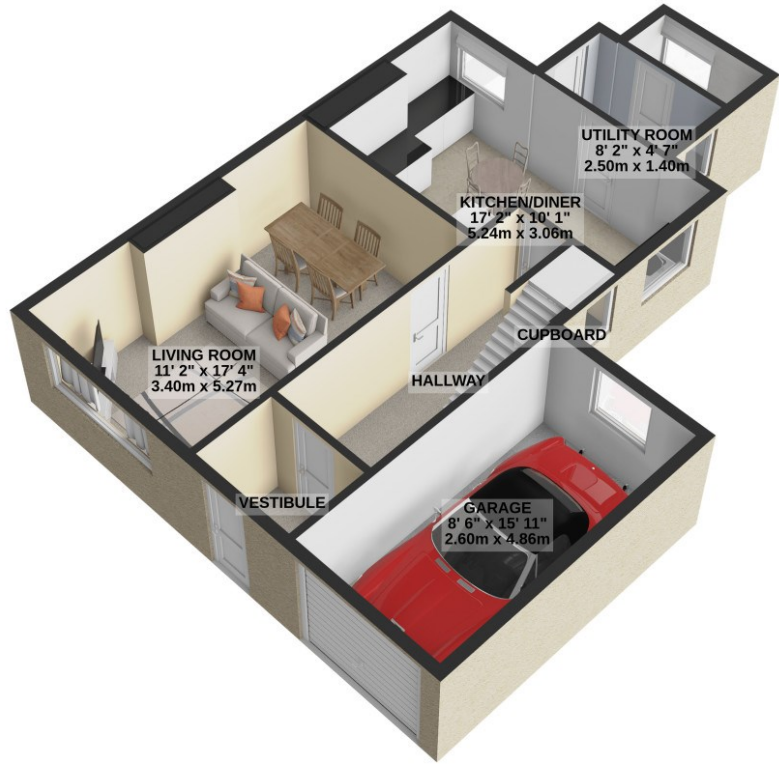

1ST FLOOR
423 sq.ft. (39.3 sq.m.) approx.

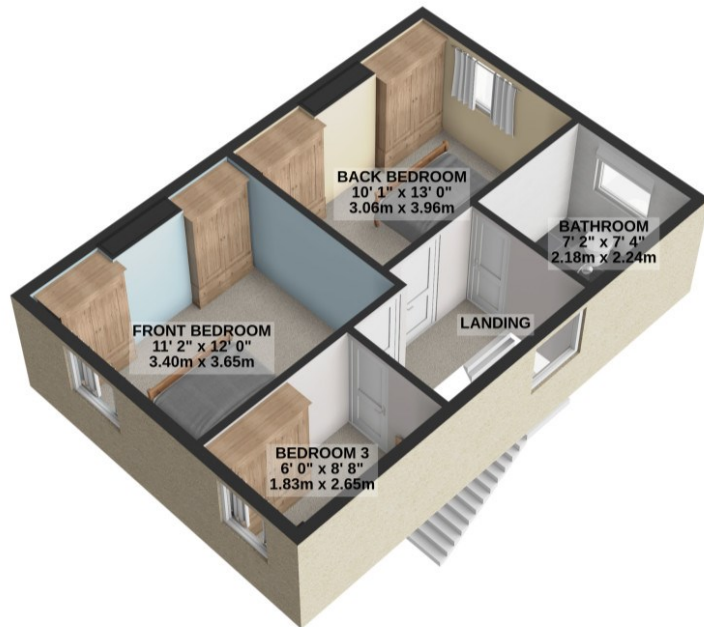

TOTAL FLOOR AREA : 1078 sq.ft. (100.2 sq.m.) approx.

For illustrative purposes only. Decorative finishes, fixtures, fittings and furnishings do not represent the current state of the property. Measurements are approximate. Not to scale.
Made with Metropix © 2024