

**16 Cherry Walk, Tromode**

**Asking Price £385,000**



**Beautifully Presented Extended Semi Detached House**

**Situated In A Sought After and Convenient Residential Location**

**Accommodation Comprises**

**Large Lounge/ Dinner**

**Lovely Fully Fitted Kitchen With Integrated Appliances**

**Outstanding Family Room with Vaulted Ceiling and Double Doors Leading to Rear Garden**

**2 Double Bedrooms 1 Further Bedroom**

**Family Bathroom**

**Large Single Garage and off Road Parking for 2 Cars**

**Good Size Easy To Maintain Rear Garden**

**u-PVC Double Glazing, All New PVC Fascias Soffits and Guttering**

**Gas Fired Central Heating**

**' Viewing's Highly Recommended'**

**Directions:** Travelling out of Douglas up Broadway continue onto the Ballaquayle Road, straight across the traffic lights onto Ballanard Road. Turn left at the mini round a bout onto Johnny Wattersons Lane Proceed down the Hill. Take your first right onto Cedar Walk then right again into Cherry Walk where the property can be found half way up on the left hand side.

Whilst all particulars are believed to be correct, neither Property Wise Limited, or their clients guarantee their accuracy nor are they intended to form part of any contract.. Floorplans are only for illustrative purposes, decorative finishes, fixtures, fittings and furnishings do not represent the current state of the property. Measurements are approximate and not to scale.



**GROUND FLOOR**  
816 sq.ft. (75.8 sq.m.) approx.

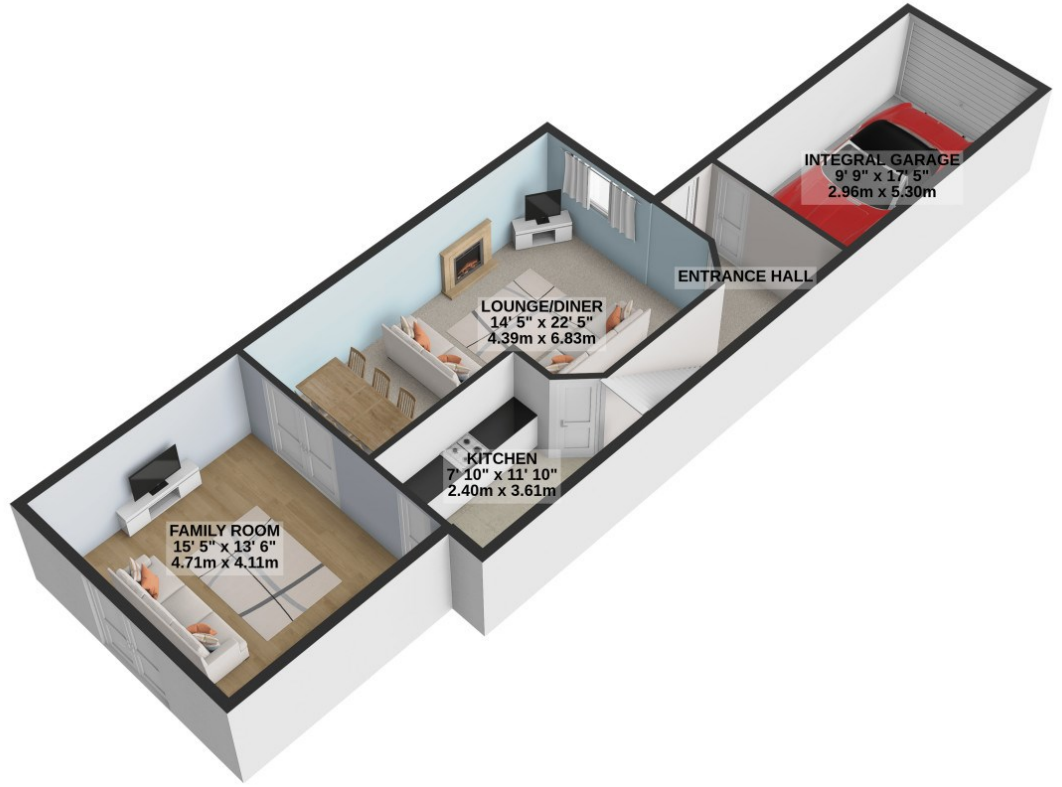

**1ST FLOOR**  
398 sq.ft. (37.0 sq.m.) approx.

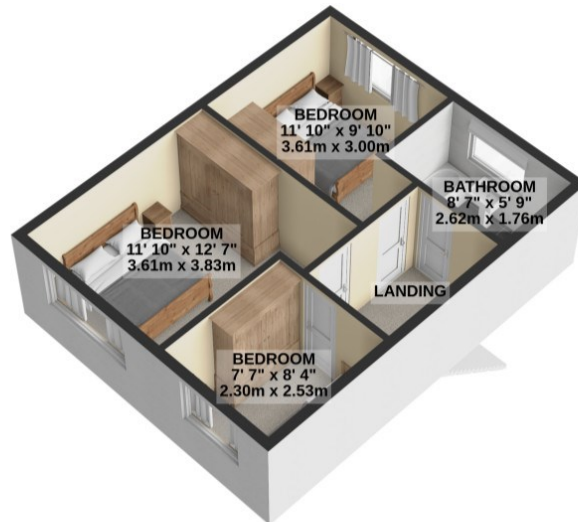

**TOTAL FLOOR AREA : 1213 sq.ft. (112.7 sq.m.) approx.**

For illustrative purposes only. Decorative finishes, fixtures, fittings and furnishings do not represent the current state of the property. Measurements are approximate. Not to scale.

Made with Metropix © 2024

Property Wise Limited, First Floor, St. Georges Chambers,  
1 Athol Street, Douglas, Isle of Man, IM1 1LD

Email: Info@propertywise.co.im

