

“Cooline”
Grove Mount, Ramsey
£427,500



Spacious Extended Semi-detached Period Property, Situated on a Corner Plot with Lovely Gardens, Walking Distance to Ramsey Town Centre, Schools and all Amenities.

Superb Kitchen/Family Room Extension at the Rear of the Property, Balcony on First Floor.

Accommodation Comprises:-

Ground Floor: Porch, Entrance Hall Cloaks Cupboard,

Drawing Room with Multi Fuel Stove & Bay Window, Extension to the Side with French Doors to the Side Garden,

Lounge Leading to Sun Room with Log Burner and Double Doors to Decking Patio,

Sitting Room with Original Doors to Rear Patio,

24' Kitchen/Dining, Family Room with Vaulted Ceiling and Access to Rear Garden.

First Floor: Bedroom One, with Bay Window, Bedroom Two with Doors to Balcony,

Bedroom Three, Family Bathroom & Separate Shower Room,

Second Floor: Bedroom 4 and Large Landing area Ideal for Study.

Oil Fired Central Heating, Partly Double Glazed.

Timber Garage, Beautiful Gardens with Established Trees and Shrubs.

‘Ideal Large Family Home, In need of Some Updating’

“NO ONWARD CHAIN”

Directions: Travelling from Ramsey town centre north towards Andreas on Bowring Road, past Ramsey Cottage Hospital, take the second turning on the right into Grove Mount continue straight ahead, turn left onto Grove Mount Lane and the property can be found straight ahead on a corner plot easily identified by our 'for sale' boards.

Rates: please contact the rates office on 685661

Tenure: Freehold

Services: mains drainage and oil fired central heating.

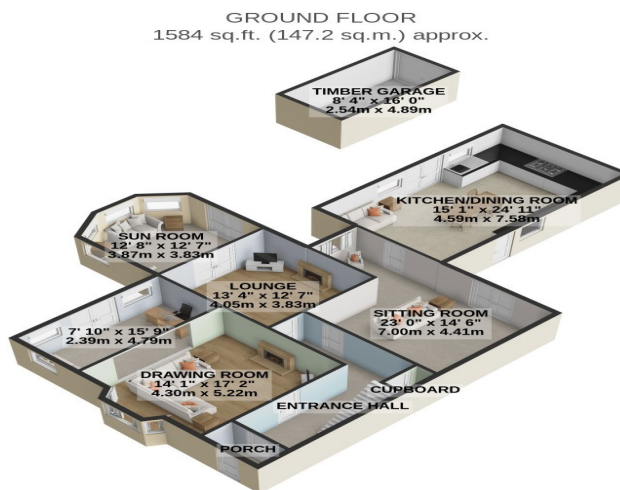

1ST FLOOR
811 sq.ft. (75.4 sq.m.) approx.



2ND FLOOR
389 sq.ft. (36.2 sq.m.) approx.

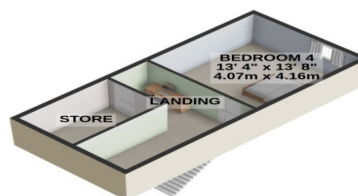

TOTAL FLOOR AREA : 2785 sq.ft. (258.7 sq.m.) approx.

For illustrative purposes only. Decorative finishes, fixtures, fittings and furnishings do not represent the current state of the property. Measurements are approximate. Not to scale. Made with Metropix © 2024