

**Sylvan Hills  
Claughbane Road Ramsey  
£530,000**



**An Well Presented 3 Bed Detached Bungalow Sat On A Generous Private Plot Surrounded By Lawned Gardens And Patio Areas In A Quiet Sought After Cul-De-Sac Within Walking Distance of Ramsey Town Centre And All Its Amenities**

**Accommodation Comprises:-**

Spacious Lounge With Views To The Hills And The Garden  
Dining Room That Leads To A Dual Aspect Modern Kitchen Overlooking The Patio Areas  
Separate Utility Room  
Good Sized Study  
3 Double Bedrooms  
Spacious Bespoke Shower Room  
Lovely Garden Room Sits Off The Rear Patio  
Large Detached Garage  
Generous Well Maintained Patio and Garden Areas That Gets The Sun Throughout The Day

**Viewings of This Lovely Property Are Highly Recommended**



**Directions:** From Parliament Square head towards the Mountain Road Out of Ramsey. Travelling Up May Hill Cloughbane can be found on the right hand side before the start of the Mountain Road (Whitegates) The Property can be found on the right hand side where our board should be clearly visible.

**Rates payable:** TBA

**Inclusions:** to be confirmed



**GROUND FLOOR**  
1625 sq.ft. (151.0 sq.m.) approx.

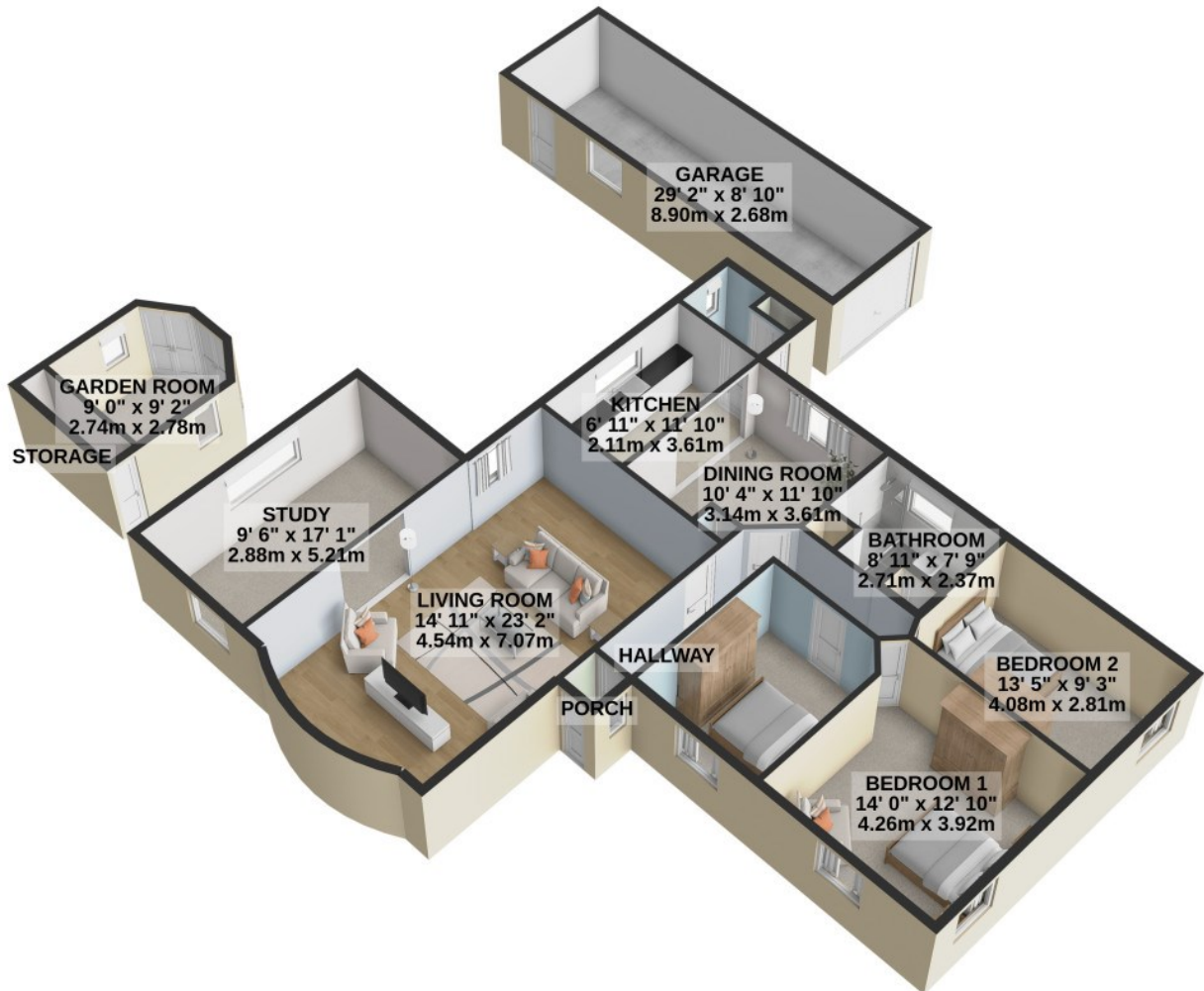

**TOTAL FLOOR AREA :** 1625 sq.ft. (151.0 sq.m.) approx.

For illustrative purposes only. Decorative finishes, fixtures, fittings and furnishings do not represent the current state of the property. Measurements are approximate. Not to scale.

Made with Metropix © 2024