

21 Julian Road, Douglas

Asking Price £295,000



Deceptively Spacious Extended Semi Detached Bungalow

Situated in a Popular Residential Location

Very Well Presented Throughout (Turn Key)

Accommodation Comprises:

Large Lounge Diner

Modern Fitted Breakfast Kitchen

2 Double Bedrooms

Modern Family Shower Room

Gas Fired Central Heating

Modern uPVC Double Glazing Throughout

Low Maintenance Rear Garden with Large Shed

Driveway Parking

Viewings Highly Recommended

Directions: Travelling North out of Douglas , up Johnny Wattersons Lane Proceed up for about 800 Yards taking the 3rd Turn in to Snaefell Road, Take Next Left on to Glen Park Drive Then Follow Road to Right and Right Again on to Julian Road where Number 21 Can be easily Found on the Left Hand Side Clearly Identified by Our

GROUND FLOOR
897 sq.ft. (83.3 sq.m.) approx.

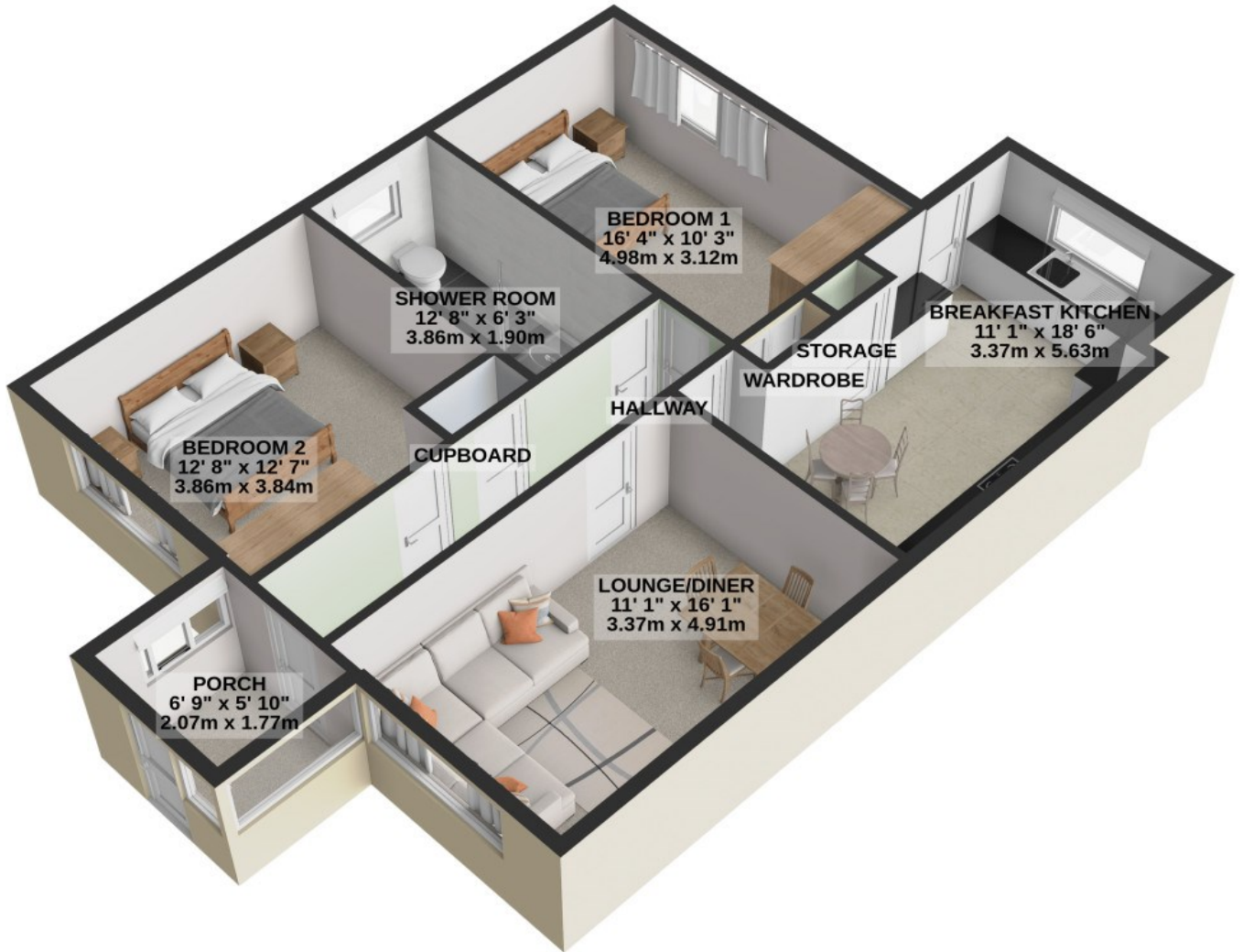

TOTAL FLOOR AREA : 897 sq.ft. (83.3 sq.m.) approx.

For illustrative purposes only. Decorative finishes, fixtures, fittings and furnishings do not represent the current state of the property. Measurements are approximate. Not to scale.

Made with Metropix © 2024

