

“Curlew Cottage”

Bride, IM7 4AW

£439,950



**Delightful Detached True Manx Cottage, Sitting in Approx Half an Acre of Beautiful Gardens,
Stunning Views to the Rear over Countryside and out to the Hills.**

**This Lovely Cottage has been Extended but there is Plenty of Room to Extend Further,
(subject to relevant planning permission)**

Detached Garage built approx. 10 years ago, Driveway for Several Vehicles.

Recently Updated with New Boiler (2years old) New Electric Circuit Board and Partially Rewired.

Combination of Hardwood & uPVC Double Glazing.

Accommodation Comprises:-

Entrance Hall, Sitting Room, Fitted Kitchen/Diner Recently Rewired,

Spacious Lounge with Dining Area, French Doors to Rear Garden,

Small Office & WC.

Landing, Two Double Bedrooms (one with fitted wardrobes) Bathroom,

There are Two Log burners fitted but they are not Certificated (they can be left or taken out)

“Lifestyle Chocolate Box Cottage full of Charm and Character”

Directions: Travelling from Parliament Square Ramsey north towards Andreas, turn right onto the Bride Road and continue along past the Dog Mills and towards Bride, take the turning on the left onto Ballacorey Road and continue to the right past the converted Chapel, the property can be found on the left hand side easily identified by our 'for sale' board.

Rates: please contact the rates office on 685661

Tenure: Freehold

Services: private drainage and oil fired central heating.

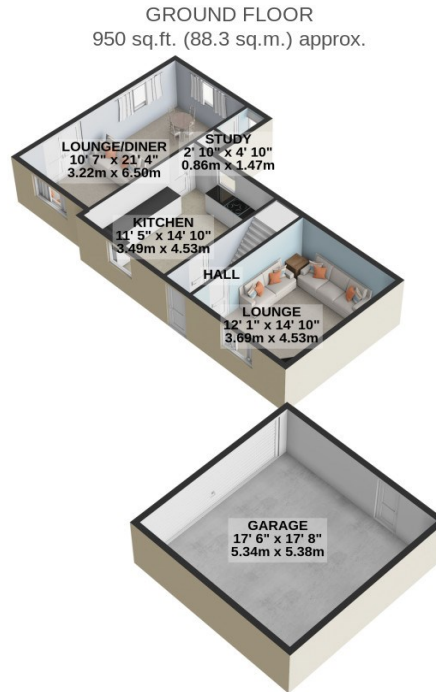

1ST FLOOR
401 sq.ft. (37.2 sq.m.) approx.

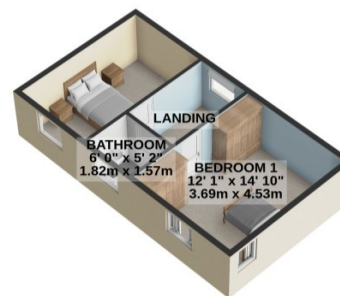

TOTAL FLOOR AREA : 1351 sq.ft. (125.5 sq.m.) approx.

For illustrative purposes only. Decorative finishes, fixtures, fittings and furnishings do not represent the current state of the property. Measurements are approximate. Not to scale.
Made with Metropix © 2024