

37 Farmhill Meadows, Douglas

Asking Price £359,950



Deceptively Spacious Semi Detached House

Situated in a Popular Residential Location

Close to Local Schools and Shops

Property Comprises:

Large Lounge Diner

Kitchen, Utility Room

Downstairs WC

3 Bedrooms

Newly Fitted Lovely Modern Bathroom

Garage Fully Converted in to Extra Reception Room or 4th Bedroom

Private Garden with No Overlooked Aspect to Rear

Driveway Parking for 2 Cars

Modern uPVC Double Glazing Throughout

Gas Fired Central Heating

Viewings Highly Recommended

Directions: Travelling Out of Douglas Along Peel Road, Turn Left at Braddan Church on to Saddle Road then Right on to Vicarage Road, Continue up to 2nd Roundabout Turning Left on to Stevenson Way, Then 3rd Right on to Farmhill Meadows. Follow Road Around to the Right Where the Property can be Found on the Left Hand Side Clearly Identified by our For Sale Board.

Whilst all particulars are believed to be correct, neither Property Wise Limited, or their clients guarantee their accuracy nor are they intended to form part of any contract. Floorplans are only for illustrative purposes, decorative finishes, fixtures, fittings and furnishings do not represent the current state of the property. Measurements are approximate and not to scale.



GROUND FLOOR
655 sq.ft. (60.8 sq.m.) approx.

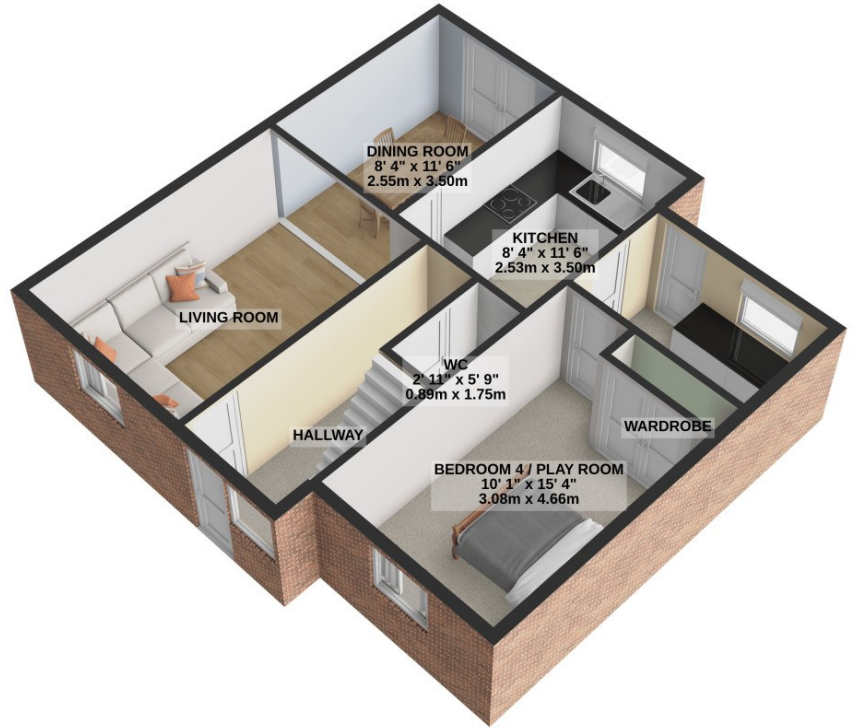

1ST FLOOR
427 sq.ft. (39.6 sq.m.) approx.

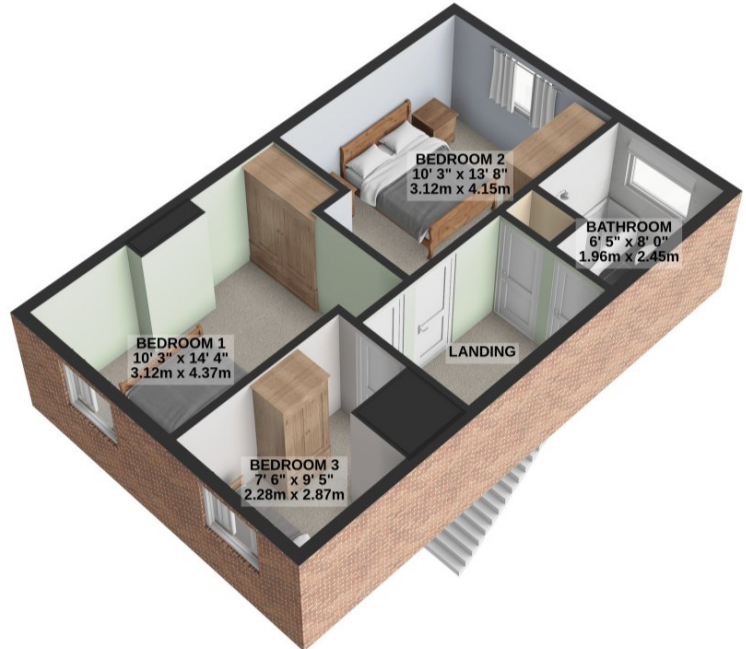

TOTAL FLOOR AREA : 1081 sq.ft. (100.5 sq.m.) approx.

For illustrative purposes only. Decorative finishes, fixtures, fittings and furnishings do not represent the current state of the property. Measurements are approximate. Not to scale.
Made with Metropix © 2024