

**10 Mountain View
Ballaugh, IM7 5EW
£549,950**



**Spacious Detached Property situated in Sought After Location of Ballaugh Village,
Stunning Rural Views, Close to Beach, School and Local Amenities.**

Private Rear Garden with Views over Agricultural Fields.

Accommodation Comprises:

Entrance Hall, Cloakroom WC, Lounge, Dining Room,

Sun Room, Breakfast Kitchen, Utility Room, Conservatory,

Bedroom 1/Guest Annex with Fitted Wardrobes, Shower Room (wet room style)

**First Floor: Bedroom 2 Views to Hills Fitted Wardrobes, En-suite, Dressing Area,
Family Bathroom, Bedroom 3 Stunning Views and Fitted Wardrobes, Bedroom 4 Large
Double with Rural Views.**

Double Garage, Garden Store, Summerhouse with Decking Pergola and BBQ Area.

Beautiful Gardens with Large Lawn Area, Mature Shrubs and Decorative Borders.

“Viewings Highly Recommended on This Large Family Home”

Directions: Travelling from Parliament Square Ramsey on Lezayre Road, Follow the Road Through Sulby and onto Ballaugh, on entering the village turn right at the bridge past the shop and take the second right onto Mountain View continue straight ahead and to the right. The property can be found on the left hand side.

Rates: please contact the rates office on 685661

Tenure: Freehold

Services: Mains drainage and Oil fired central heating.



GROUND FLOOR
1707 sq.ft. (158.6 sq.m.) approx.

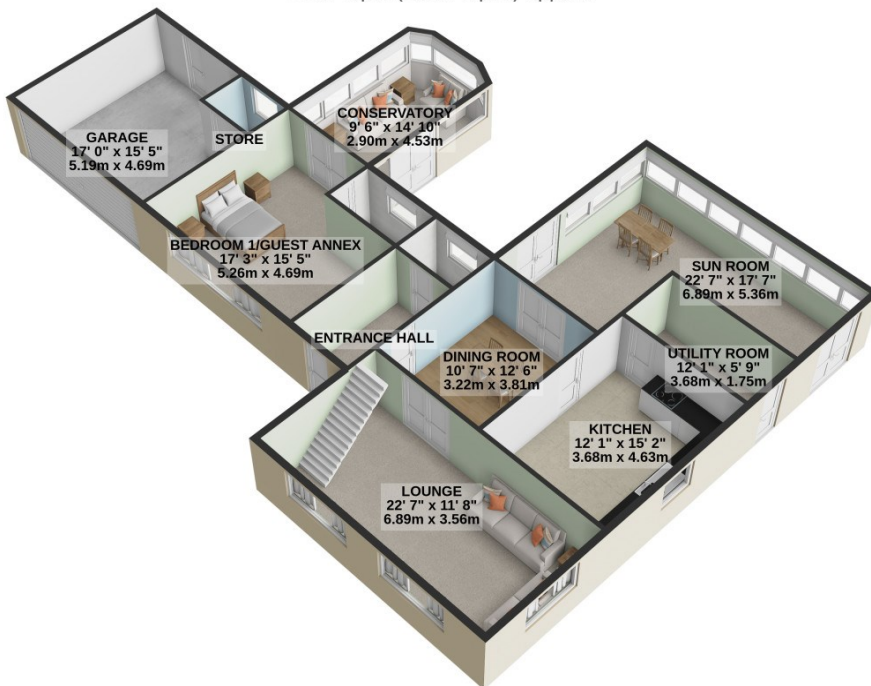

1ST FLOOR
1003 sq.ft. (93.2 sq.m.) approx.

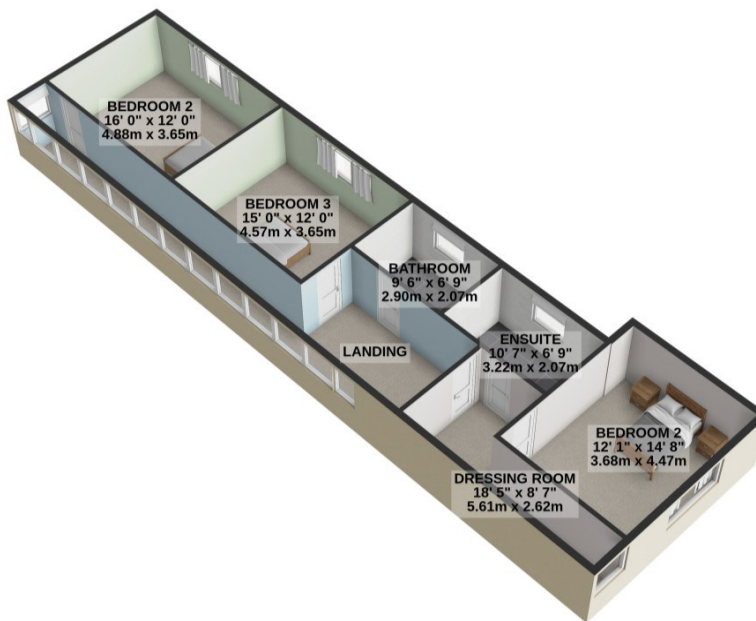

TOTAL FLOOR AREA : 2710 sq.ft. (251.8 sq.m.) approx.

Property Wise Limited, 21 Parliament Street,
Ramsey, Isle of Man, IM8 1AS
Email: Info@propertywise.co.im